

- NOTES:
- 1. DIMENSIONS IN INCHES.
 - 2. BREAK EDGES .02 MAX.
 - 3. ELECTROLESS NICKEL PLATE PER ASTM B733-04 TYPE V (10% MIN PHOSPHORUS), SC1 (.0002" THK), CLASS 4.

	A	REMOVE HOLE & CHNG 3X4.791 TO 2X4.791 & CHNG 2X3.698 TO 3.698; CHNG 2XR.14 TO 2XR.15	MDK	9/19/2011	
	-	INITIAL RELEASE	JD	7/12/2010	
ZONE	REV	DESCRIPTION	BY	DATE	APV BY
REVISIONS					

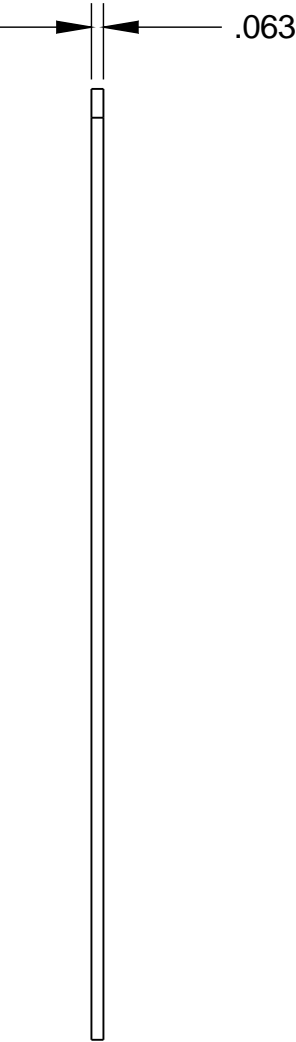
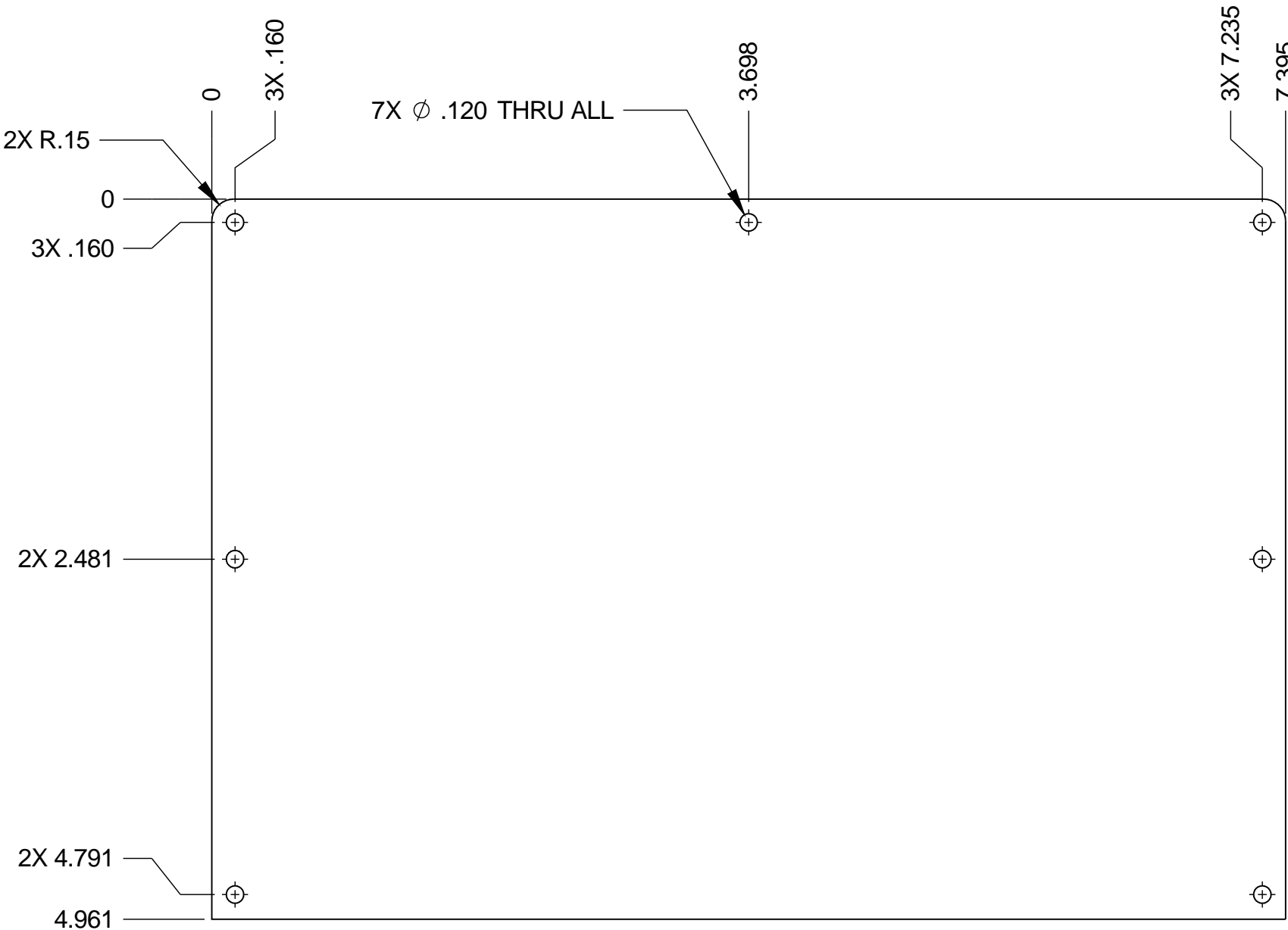

-1	
ITEM	WEIGHT (Lbs)
CALCULATED WEIGHT	

MATERIAL : ALUMINUM ALLOY 6061-T6					
TOLERANCES UNLESS OTHERWISE NOTED .XX ±.01 .XXX ±.005		ANGULAR ±.1°		THIRD ANGLE PROJECTION	
DO NOT SCALE DRAWING		NAME		USED ON	
NEXT ASSEMBLY		TRANSITION MODULE BASE FRONT COVER		TORRENT	
SCALE: 1:1		DESIGNED BY: RATH / DeVRIES		CHECKED BY: XXX	
DWG PRODUCED USING SOLIDWORKS 2010		DRAWN BY: XXX		APPROVED BY: XXX	
				DRAWING NUMBER TRNT-EL-02-1029	
				RELEASE DATE:	
				SHEET: 1 OF 1	